



**FITTING INSTRUCTIONS FOR LP0204BK LICENCE PLATE BRACKET**  
**YAMAHA MT-10 '16-**



**THIS KIT CONTAINS THE ITEMS PICTURED AND LABELLED BELOW.**  
**DO NOT PROCEED UNTIL YOU ARE SURE ALL PARTS ARE PRESENT.**

Please note that the way the kit is packed does not necessarily represent the way of mounting to the bike

THE PARTS SHOWN MAY BE REPRESENTATIVE ONLY (FOR CLARITY OF INSTRUCTIONS ONLY)

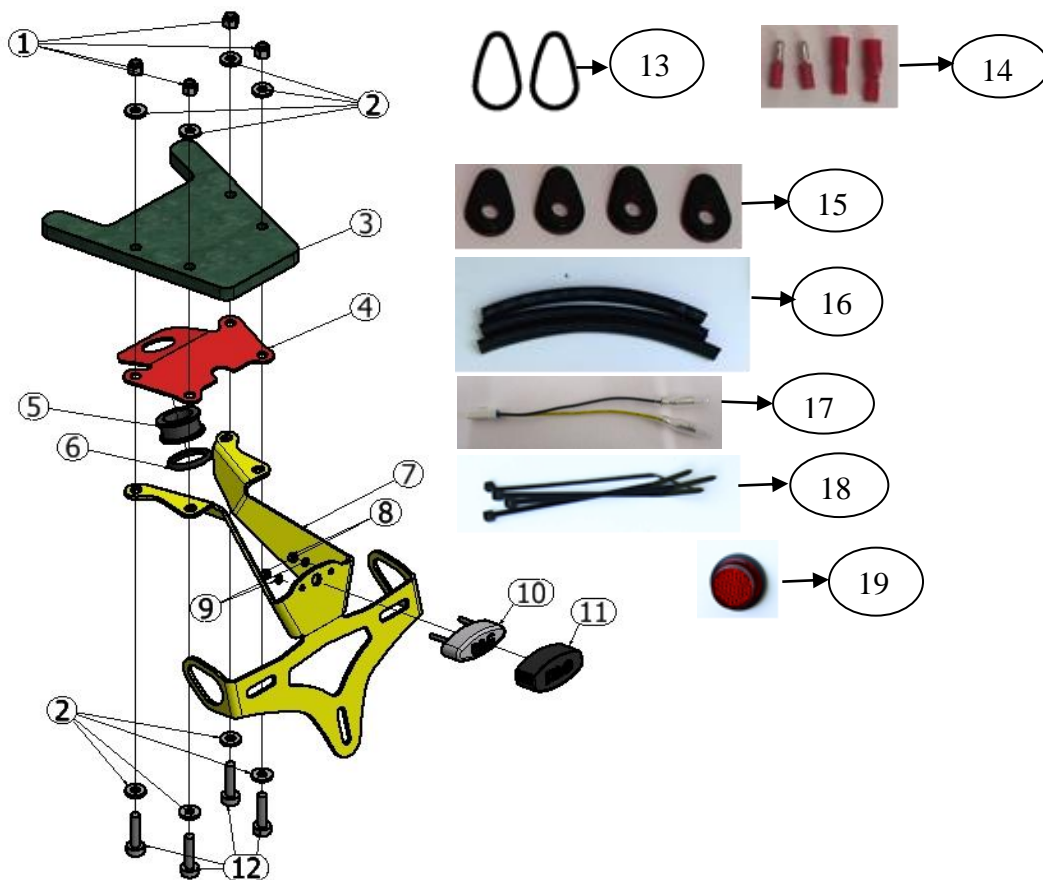



## **LEGEND**

- ITEM 1 = M6 NYLOC NUTS (x4)  
ITEM 2 = M6 WASHERS (x8).  
ITEM 3 = OEM SUB-FRAME (NOT INCLUDED IN THE KIT, FOR ILLUSTRATION ONLY)  
ITEM 4 = KEY-LOCK COVER PLATE (TB0204) (x1)  
ITEM 5 = RB0002 (UNDERTRAY BUNG) (x1)  
ITEM 6 = O-RING (OR0006) (x1)  
ITEM 7 = LICENCE PLATE MOUNTING BRACKET (TB0178) (x1).  
ITEM 8 = M3 NUT (x2)  
ITEM 9 = M3 WASHERS (x2)  
ITEM 10 = LICENCE PLATE ILLUMINATOR (LA0002) (x1)  
ITEM 11 = LICENCE PLATE ILLUMINATOR SHROUD (x1)  
ITEM 12 = M6 x 25mm LONG BOLTS (x4)  
ITEM 13 = ORIGINAL INDICATOR SPACERS (I0037) (x2).  
ITEM 14 = BULLET CONNECTORS (CON0004) (x2 set)  
ITEM 15 = MINI INDICATOR ADAPTORS (I0016) (x4)  
ITEM 16 = 180mm LENGTHS OF HEAT SHRINK TUBES (x3)  
ITEM 17 = LICENCE PLATE ILLUMINATOR CONNECTOR (CON0014) (x1)  
ITEM 18 = 220mm CABLE TIES (x3)  
ITEM 19 = REFLECTOR (REFL 1) (x1)

Page | 2

Please note that in cases where kits are packed with rubber washers holding the components onto the bolt – *the rubber washers should be thrown away!*

## **TOOLS REQUIRED**

- Set of metric Allen keys to include 4 - 6 A/F size.
- Socket set to include 8 and 10mm A/F socket and wrench.
  - Phillip screwdriver
  - Small amount of super glue.

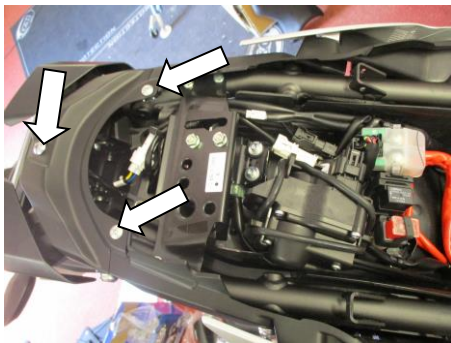

PICTURE 1



PICTURE 2



PICTURE 3

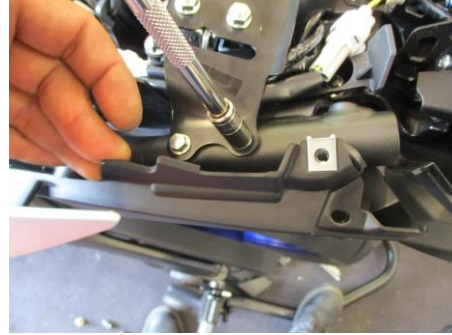

PICTURE 4

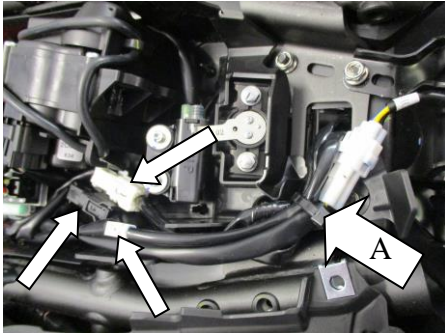

PICTURE 5

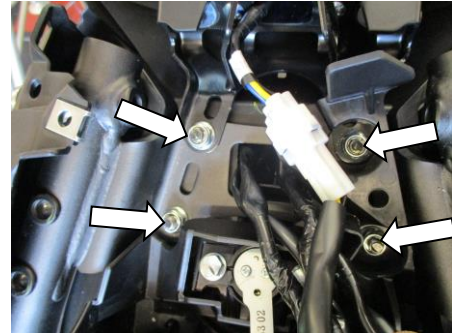

PICTURE 6

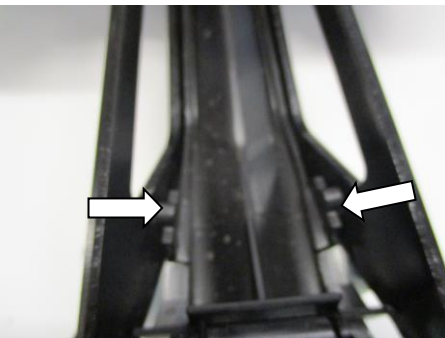

PICTURE 7

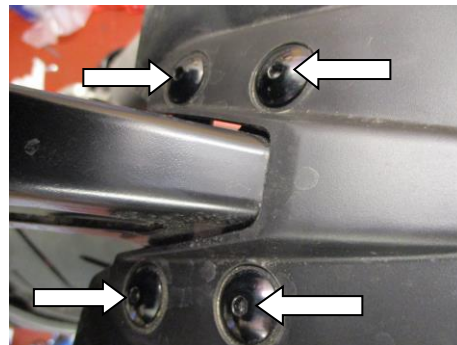

PICTURE 8



PICTURE 9

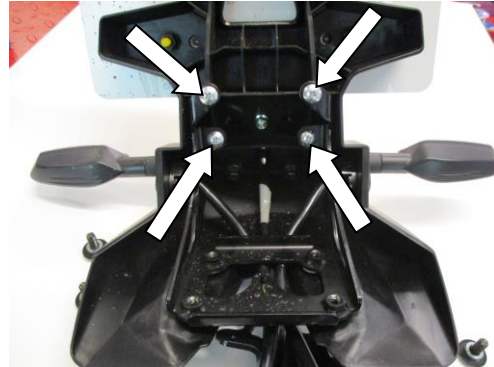

PICTURE 10



PICTURE 11

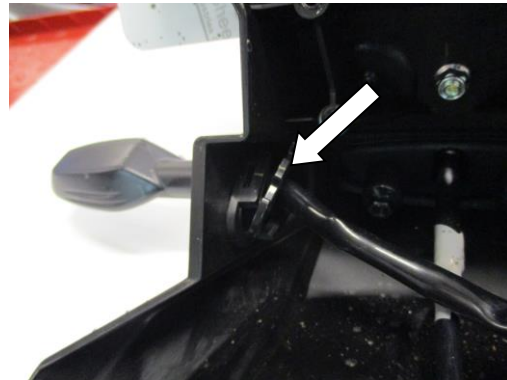

PICTURE 12



PICTURE 13



PICTURE 14



PICTURE 15



PICTURE 16

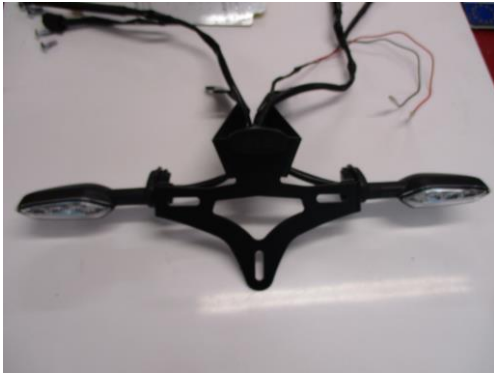

PICTURE 17



PICTURE 18



PICTURE 19



PICTURE 20

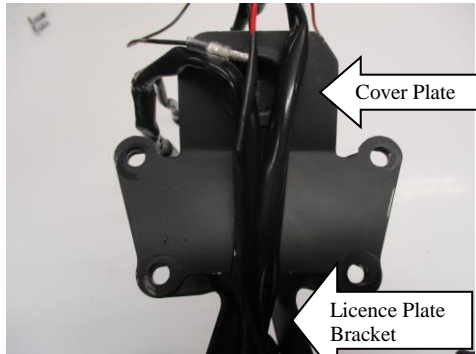

PICTURE 21



PICTURE 22

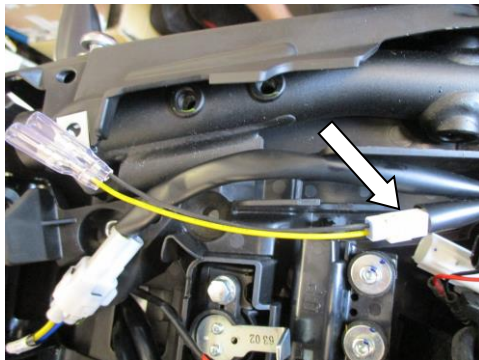

PICTURE 23

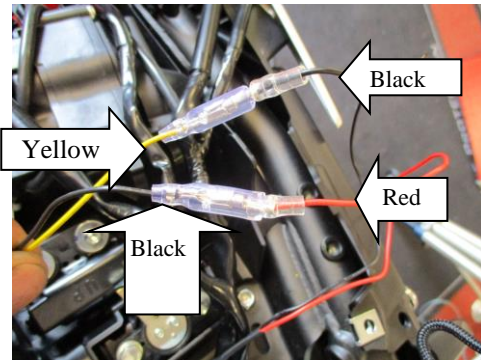

PICTURE 24

**FITTING INSTRUCTIONS**

- Remove the seat using the key
- Remove the 3 bolts arrowed in Picture 1 using 4mm Allen key and a Phillip screwdriver.
- Starting from the LHS of the bike, loosen the two bolts arrowed in Picture 2 using a 6mm Allen key. It is not necessary to remove the bolts completely. Repeat the procedure for the RHS bolts.
- Remove the four bolts arrowed in picture 3. Gently pull the side panels aside and remove the four bolts using 8mm socket and a wrench as shown in picture 4. Remove the seat lock bracket.
- Disconnect all tail unit connectors as arrowed in picture 5. *Please note the orientation of the connectors.* Cut the cable tie that holds all the wiring (Labelled A in Picture 5).
- Remove the four nuts arrowed in Picture 6 using a 10mm socket and a wrench. Keep the tail unit supported at this stage while undoing the nuts. Gently withdraw the whole tail unit assembly and the wiring off the sub-frame.



- On the OEM tail unit assembly, remove the plastic cover located on the centre underside of the bracket. Unclip the two clips arrowed in Picture 7 and withdraw the plastic cover.
- Remove the four bolts arrowed in Picture 8 using a 4mm Allen key. Keep the OEM licence plate bracket supported at this stage. Remove the bracket once all bolts are removed as shown in Picture 9.
- Remove the four screws arrowed in Picture 10 using a Phillip screwdriver. Remove the bracket as shown in Picture 11.
- Remove the spreader/ clamp plate on each indicator as shown in Picture 12.
- Remove both indicators from the OEM tail unit as shown in Picture 13.
- From the kit, take the R&G Licence plate bracket (Item 7) and fit both indicators as original to the bracket.
- From the kit, take the OEM indicator adaptor and fit it on the inside of the indicator stem as shown in Picture 14. Repeat the procedure to the other indicator. Shown in Picture 15.
- If using Mini Indicators, fit the indicators using the four mini indicator adaptors (Item 15) provided. Please use heat shrink tube (Item 16) provided in the kit to protect the wiring.
- From the kit, take the licence plate illuminator (Item 10) and fit it through the three in-line holes located in the top centre of the Licence plate bracket (Item 7). Secure with M3 washers and nuts provided as shown in Picture 16.
- Take Licence plate illuminator shroud (Item 11), apply a small amount of super glue on the inside and place it over the licence plate illuminator (Item 10).
- When all the lights are fitted it should look as the picture shown in Picture 17.
- From the kit, take the rubber bung (Item 5) and the O-Ring (Item 6). Insert the O-Ring (Item 6) onto the rubber bung (Item 5) as shown in Picture 18. It should look as shown in Picture 19 when finished.
- From the kit, take the key-lock cover plate (Item 4) and insert the Rubber bung assembly just built as shown in Picture 20. Ensure that the O-ring (Item 6) sits below the cover plate (Item 4).
- Place the key-lock cover assembly on top of the licence plate bracket assembly with the rubber bung facing upwards. Locate the wiring to sit on the slot provided on the cover plate (Item 4). Align the four mounting holes as shown in Picture 21.
- Offer the whole assembly towards the bike, push all wiring through the centre hole of the sub-frame as original. Align the four mounting holes and insert the four M6 bolts (Item 12) and washers (Item 2) from below as shown in Picture 22. Secure the assembly with M6 washers (Item 2) and Nyloc nuts (Item 1). Ensuring that there are no wires being caught between the licence plate bracket assembly and the sub-frame, tighten the four M6 nyloc nuts to 15Nm.



- From the kit, take the Licence plate illuminator connector (Item 17). Connect the male side into the OEM female connector in the main loom as arrowed in Picture 23.
- Connect the female licence plate illuminator connectors just fitted onto the licence plate illuminator connectors in this wiring scheme:  
Connector Yellow -----→ Illuminator Black  
Connector Black -----→ Illuminator Red  
Wiring scheme also shown in Picture 24. If light fails to illuminate, please swap the connectors around.
- Connect the indicator connectors as original.
- If using mini indicators, it is advised that you cut and shut the original wires so you can reuse the original plug sockets.
- Tidy all wiring using the cable ties (Item 18) provided in the kit.
- Refit the OEM seat lock bracket and the panel removed earlier as original.
- At this stage it is advisable to check all the lights and seat lock for full working operations.
- Fit licence plate to new licence plate bracket (it may require re-drilling).
- **IMPORTANT: IF FITTING A FULL-SIZE LICENCE PLATE AND PLACING IT FAR DOWN ON THE LICENCE PLATE HANGER, THERE IS A SMALL CHANCE OF THE LICENCE PLATE HITTING THE BACK WHEEL UNDER HEAVY LOAD AND OVER LARGE BUMPS IN THE ROAD. IT IS YOUR RESPONSIBILITY TO CHECK FOR THIS POSSIBILITY AND TAKE AVOIDING ACTION. FAILURE TO CHECK THIS COULD RESULT IN SERIOUS INJURY.**
- Refit the seat.
- Depending on local laws, attach enclosed red reflector (item 19) in an appropriate location.
- Please test the indicators, rear light and licence plate illuminator before riding.

**ISSUE 2 16/06/2016 (HH)**  
**CONSUMER NOTICE**

The catalogue description and any exhibition of samples are only broad indications of the Products and R&G may make design changes which do not diminish their performance or visual appeal and supplying them in such state shall conform to the order. The Buyer acknowledges no representation or warranty (other than as to title) has been given or will apply to the Products other than those in R&G's order or confirmation and the Buyer confirms it has chosen the Products as being of merchantable quality and suitable for its particular purposes. Where R&G fits the Products or undertakes other services it shall exercise reasonable skill and care and rectify any fault free of charge unless the workmanship has been disturbed. The Buyer is responsible for ensuring that the warranty on the motorcycle is not affected by the fitting of the Products. On return of any defective Products R&G shall at its option either supply a replacement or refund the purchase money but shall not be liable if the Products have been modified or used or maintained otherwise than in accordance with R&G's or manufacturer's instructions and good engineering practice or if the defect arises from accident or neglect. Other than identified above and subject to R&G not limiting its liability for causing death and personal injury, it shall not be liable for indirect or consequential loss and otherwise its liability shall be limited to the amounts paid by the Buyer for the Products or the fitting or service concerned. These terms do not affect the Buyer's statutory rights.

**R&G RACING RETURNS POLICY (NON-FAULTY GOODS)**

Returns must be pre-authorized (if not pre-authorized the return will be rejected). Goods may only be returned direct to us if they were purchased direct from us (customer must prove if necessary). Otherwise to be returned to original vendor. Goods must be in re-sellable condition, in the opinion of R&G Racing. All returns are subject to a 25% restocking and handling fee (25% of the gross value exc. P&P – at the prevailing price at time of purchase). The customer must pay any and all carriage charges. No returns of discontinued products, unless within 14 days of purchase. This policy does not affect your statutory rights and does not refer to faulty goods.





**NOTICE DE MONTAGE POUR LP0204BK SUPPORT DE PLAQUE**  
**YAMAHA MT-10 '16-**



**Le kit contient les articles exposés ci-dessous, vérifier que toutes les pièces soient présentes avant de procéder au montage.**

**LA FAÇON DONT LE KIT EST EMBALLE NE CORRESPOND PAS FORCEMENT A LA FAÇON DE MONTER LES PIÈCES SUR LA MOTO.**

**LES PARTIES PRESENTEES PEUVENT ETRE UNIQUEMENT REPRESENTATIVES (POUR LA CLARTE DES INSTRUCTIONS UNIQUEMENT)**

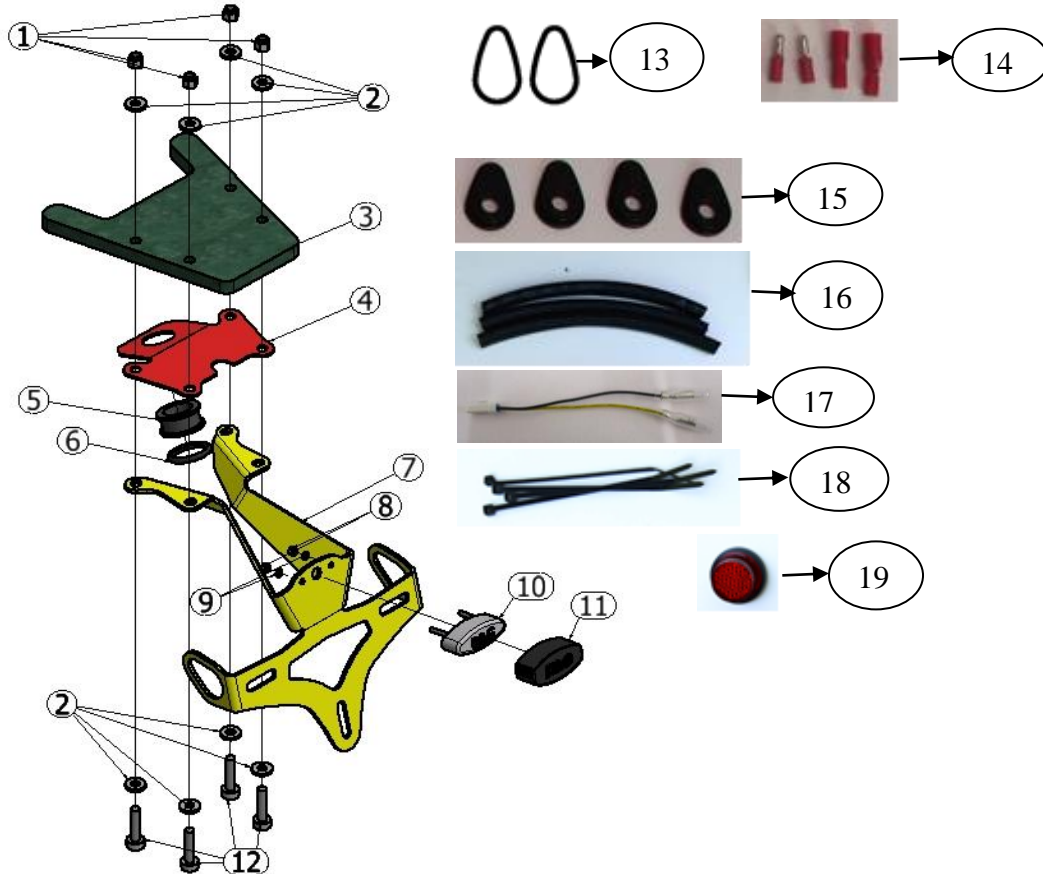



## **LEGENDE**

- ARTICLE 1 = M6 ECROUS (x4)  
ARTICLE 2 = M6 RONDELLES (x8).  
ARTICLE 3 = SOUS CADRE D'ORIGINE (NON INCLUS DANS LE KIT, POUR ILLUSTRER UNIQUEMENT)  
ARTICLE 4 = CACHE SERRURE (TB0204) (x1)  
ARTICLE 5 = RB0002 (BONDE PASSAGE DE ROUE) (x1)  
ARTICLE 6 = BAGUE-O (OR0006) (x1)  
ARTICLE 7 = LICENCE PLATE MOUNTING BRACKET (TB0178) (x1).  
ARTICLE 8 = M3 ECROU (x2)  
ARTICLE 9 = M3 RONDELLES (x2)  
ARTICLE 10 = FEU DE PLAQUE (LA0002) (x1)  
ARTICLE 11 = LINCEUL FEU DE PLAQUE (x1)  
ARTICLE 12 = M6 x 25mm BOULONS (x4)  
ARTICLE 13 = ENTRETOISES CLIGNOTANT D'ORIGINE (I0037) (x2).  
ARTICLE 14 = CONNECTEURS (CON0004) (x1 set)  
ARTICLE 15 = ADAPTATEURS MINI CLIGNOTANTS (I0016) (x4)  
ARTICLE 16 = 180mm TUBES THERMO RETRACTABLE (x3)  
ARTICLE 17 = CONNECTEUR FEU DE PLAQUE (CON0014) (x1)  
ARTICLE 18 = 220mm COLLIERS DE SERRAGE (x3)  
ARTICLE 19 = REFLECTEUR (REFL 1) (x1)

Page | 10

Notez que si les kits sont emballés avec des rondelles en caoutchouc servant à tenir les composants, *ces rondelles doivent être jetées !*

## **OUTILS REQUIS**

- Clés Allen 4 - 6.
- Jeu de clés 8 et 10mm.
- Tournevis cruciforme
- Un peu de superglue.

## **NOTICE DE MONTAGE**

- Enlever le siège à l'aide de la clé.
- Enlever les 3 boulons indiqués sur la Photo 1 en utilisant une clé Allen 4mm et un tournevis cruciforme.
- En partant du côté gauche de la moto, desserrer les 2 boulons indiqués sur la Photo 2 en utilisant une clé Allen 6mm. Il n'est pas nécessaire d'enlever les boulons complètement. Répéter la procédure du côté droit.
- Enlever les 4 boulons indiqués sur la photo 3. Tirer les panneaux latéraux et enlever les 4 boulons à l'aide d'une clé 8mm, voir photo
- 4. Enlever le support de blocage de siège.
- Déconnecter les connecteurs de la queue de support de plaque, voir photo 5. *Notez l'orientation des connecteurs.* Couper le collier de serrage qui fixe les fils (Etiqueté A sur la Photo 5).



- Enlever les 3 écrous, voir Photo 6 en utilisant une clé 10mm. Supporter l'unité de queue de support tout en enlevant les écrous. Retirer l'ensemble doucement et le fil du sous cadre.
- Sur l'ensemble de support d'origine, enlever le cache plastique placé au dessous au centre du support. Déclipser les 2 clips indiqués sur la photo 7 et retirer le cache plastique.
- Enlever les 4 boulons indiqués sur la Photo 8 à l'aide d'une clé Allen 4mm. Supporter le support de plaque d'origine. Enlever le support une fois tous les boulons soient enlevés, voir Photo 9.
- Enlever les 4 vis indiquées sur la Photo 10 à l'aide d'un tournevis cruciforme. Enlever le support, voir Photo 11.
- Enlever la plaque d'écartement sur chaque clignotant, voir Photo 12.
- Enlever les 2 clignotants du support de plaque d'origine, voir Photo 13.
- Dans le kit, prendre le support de plaque d'origine (ARTICLE 7) et monter les 2 clignotants comme à l'origine sur le support.
- Dans le kit, prendre l'adaptateur de clignotant d'origine et montez le à l'intérieur de la tige de clignotant, voir Photo 14. Répéter le procédure sur l'autre clignotant. Voir photo 15.
- Si vous utilisez les minis clignotants, montez-les à l'aide des 4 adaptateurs de mini clignotants (ARTICLE 15) fournis. Utiliser un tube thermo rétractable (ARTICLE 16) fournir dans le kit pour protéger les fils.
- Dans le kit, prendre le feu de plaque (ARTICLE 10) et montez sur les 3 trous alignés placés dans la partie centrale et haute du support de plaque (ARTICLE 7). Fixer les rondelles M3 et écrous fournis, voir Photo 16.
- Prendre le linceul de feu de plaque (ARTICLE 11), appliquer un peu de superglue à l'intérieur puis placez-le autour du feu de plaque (ARTICLE 10).
- Lorsque tous les feux sont installés, cela devrait ressembler à la Photo 17.
- Dans le kit, prendre la bonde en caoutchouc (ARTICLE 5) et la bague O (ARTICLE 6). Insérer la bague O (ARTICLE 6) sur la bonde en caoutchouc (ARTICLE 5) voir Photo 18. Cela devrait ressembler à la photo 19 au final.
- Dans le kit, prendre le cache serrure (ARTICLE 4) et insérer la bonde en caoutchouc, voir Photo 20. Veiller à ce que la bague O (ARTICLE 6) se place au dessous du cache (ARTICLE 4).
- Placer l'assemblage cache serrure sur le haut du support de plaque avec la bonde en caoutchouc dirigée vers le haut. Placer le fil dans la fente présente sur le cache (ARTICLE 4). Aligner les 4 trous de fixation, voir Photo 21.
- Monter l'assemblage sur la moto, pousser tous les fils dans le trou central du sous cadre comme à l'origine. Aligner les 4 trous de fixation et insérer les 4 boulons M6 (ARTICLE 12) et rondelles (ARTICLE 2) au dessous, voir Photo 22. Fixer l'ensemble avec des rondelles M6 (ARTICLE 2) et écrous (ARTICLE 1). Veiller à ce qu'il n'y ait aucun fil pincé entre l'assemblage de support de plaque et le sous cadre, serrer les 4 écrous M6 à 15Nm.



- Dans le kit, prendre le connecteur de feu de plaque (ARTICLE 17). Connecter le coté mâle dans le connecteur femelle d'origine du faisceau principal, voir Photo 23.
- Connecter les connecteurs de feu de plaque tout juste montés sur les connecteurs de feu de plaque selon ce schéma :

Connecteur Jaune -----→ Feu Noir  
Connecteur Noir -----→ Feu Rouge

Schéma indiqué sur la Photo 24. Si l'éclairage échoue, tournez les connecteurs.

- Connecter les connecteurs de clignotant comme à l'origine.
- Si vous utilisez des minis clignotants, il est conseillé de couper et fermer les fils d'origine de façon à pouvoir réutiliser les prises d'origine.
- Serrer tous les fils à l'aide de colliers de serrage (ARTICLE 18) fournis dans le kit.
- Remonter le support de blocage d'origine et le panneau enlevé précédemment, comme à l'origine.
- Vérifier tous les feux et le blocage de siège.
- Monter la plaque sur le nouveau support de plaque (Peut nécessiter un perçage).
- **IMPORTANT: Si vous installez une grosse plaque, il y a un risque que la plaque entre en contact avec la roue arrière en cas de choc sur la route (bosse, grosse charge etc...). Il est de votre responsabilité de vérifier que cela ne puisse pas se produire. Ne pas effectuer ces vérifications peut entraîner des dommages ainsi que des blessures graves pour le pilote.**
- Remettre le siège.
- Selon la loi locale, attachez le réflecteur (article 16) fourni à son emplacement approprié.
- **Vérifiez que les clignotants et les feux de plaque fonctionnent bien avant de prendre la route.**

#### ISSUE 2 16/06/2016 (HH)

##### CONSUMER NOTICE

The catalogue description and any exhibition of samples are only broad indications of the Products and R&G may make design changes which do not diminish their performance or visual appeal and supplying them in such state shall conform to the order. The Buyer acknowledges no representation or warranty (other than as to title) has been given or will apply to the Products other than those in R&G's order or confirmation and the Buyer confirms it has chosen the Products as being of merchantable quality and suitable for its particular purposes. Where R&G fits the Products or undertakes other services it shall exercise reasonable skill and care and rectify any fault free of charge unless the workmanship has been disturbed. The Buyer is responsible for ensuring that the warranty on the motorcycle is not affected by the fitting of the Products. On return of any defective Products R&G shall at its option either supply a replacement or refund the purchase money but shall not be liable if the Products have been modified or used or maintained otherwise than in accordance with R&G's or manufacturer's instructions and good engineering practice or if the defect arises from accident or neglect. Other than identified above and subject to R&G not limiting its liability for causing death and personal injury, it shall not be liable for indirect or consequential loss and otherwise its liability shall be limited to the amounts paid by the Buyer for the Products or the fitting or service concerned. These terms do not affect the Buyer's statutory rights.

##### R&G RACING RETURNS POLICY (NON-FAULTY GOODS)

Returns must be pre-authorized (if not pre-authorized the return will be rejected). Goods may only be returned direct to us if they were purchased direct from us (customer must prove if necessary). Otherwise to be returned to original vendor. Goods must be in re-sellable condition, in the opinion of R&G Racing. All returns are subject to a 25% restocking and handling fee (25% of the gross value exc. P&P – at the prevailing price at time of purchase). The customer must pay any and all carriage charges. No returns of discontinued products, unless within 14 days of purchase. This policy does not affect your statutory rights and does not refer to faulty goods.

R&G Racing

Unit 1, Shelley's Lane, East Worldham, Alton, Hampshire, GU34 3AQ

Tel: +44 (0)1420 89007 Fax: +44 (0)1420 87301 [www.rg-racing.com](http://www.rg-racing.com) Email: [info@rg-racing.com](mailto:info@rg-racing.com)